

IMPORTANT SAFETY INSTRUCTIONS. READ BEFORE STARTING.

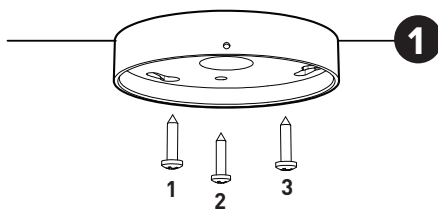

- Follow instructions carefully, failure to do so will void warranty.
- Ensure installation complies with local law and applicable standards.
- Ensure mains input power is surge protected.
- Never make connections whilst the power is connected.
- Do not make modifications or alter the product.
- Keep luminaire clean and free of debris.



Step 1 Screw the top mount to a suitable supporting surface. Fixture weight is 4kg.

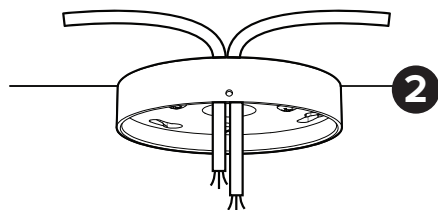

Step 2 Make a hole in the surface and feed the power cable/s through the centre hole in the top mount.

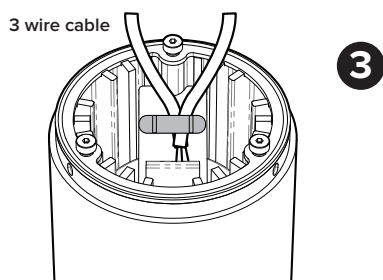

Step 3 Connect the power cable wires as shown below. Tighten the cable strain clamp.

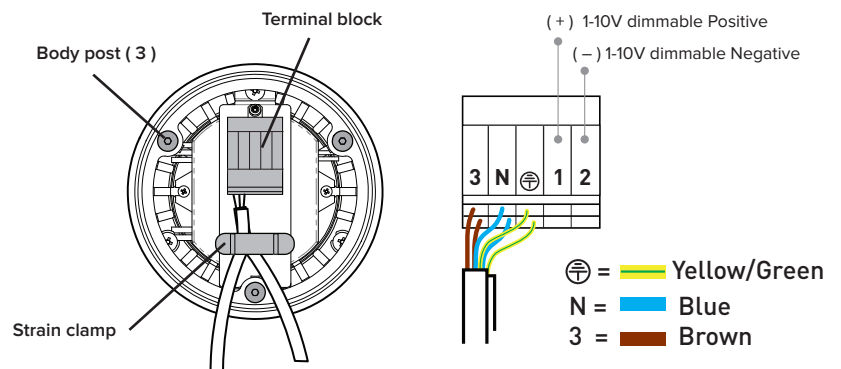

WARNING

Failure to wire correctly will damage the fixture and void the product warranty.

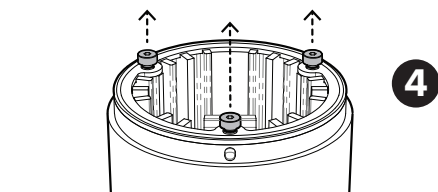

Step 4 Align the 3 body posts with the slotted holes in the top mount. Push and twist the main body clockwise to secure in place.

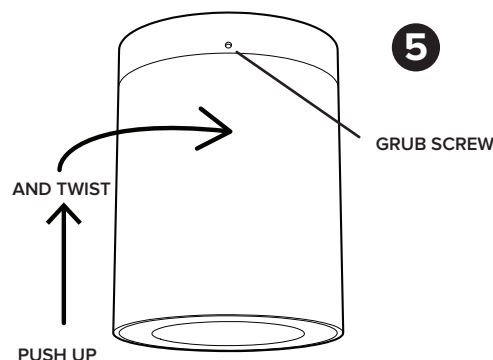

Step 5 Tighten the M5 grub screw to lock the fixture and complete installation.